

NOTES

- 01 USE WRITTEN DIMENSIONS ONLY - DO NOT SCALE.
- 02 CHECK ALL DIMENSIONS ON SITE BEFORE COMMENCING CONSTRUCTION.
- 03 THE BUILDER SHOULD CONFIRM BOUNDARY LOCATION, SETBACKS AND SERVICE LOCATIONS BEFORE COMMENCING CONSTRUCTION.
- 04 THE BUILDER SHOULD REFER ANY ERRORS OR OMISSIONS ON THESE PLANS TO EDDY DESIGN FOR AMENDMENT.
- 05 THE BUILDER SHOULD REFER ANY PROPOSED ALTERATION TO THESE PLANS TO EDDY DESIGN FOR APPROVAL.
- 06 ALL WORK TO COMPLY FULLY WITH THE B.C.A., RELEVANT AUSTRALIAN STANDARDS, ACCEPTABLE BUILDING PRACTICE AND REQUIREMENTS OF THE G.S.C., ALL OF WHICH TAKE PRECEDENCE OVER THESE DRAWINGS.

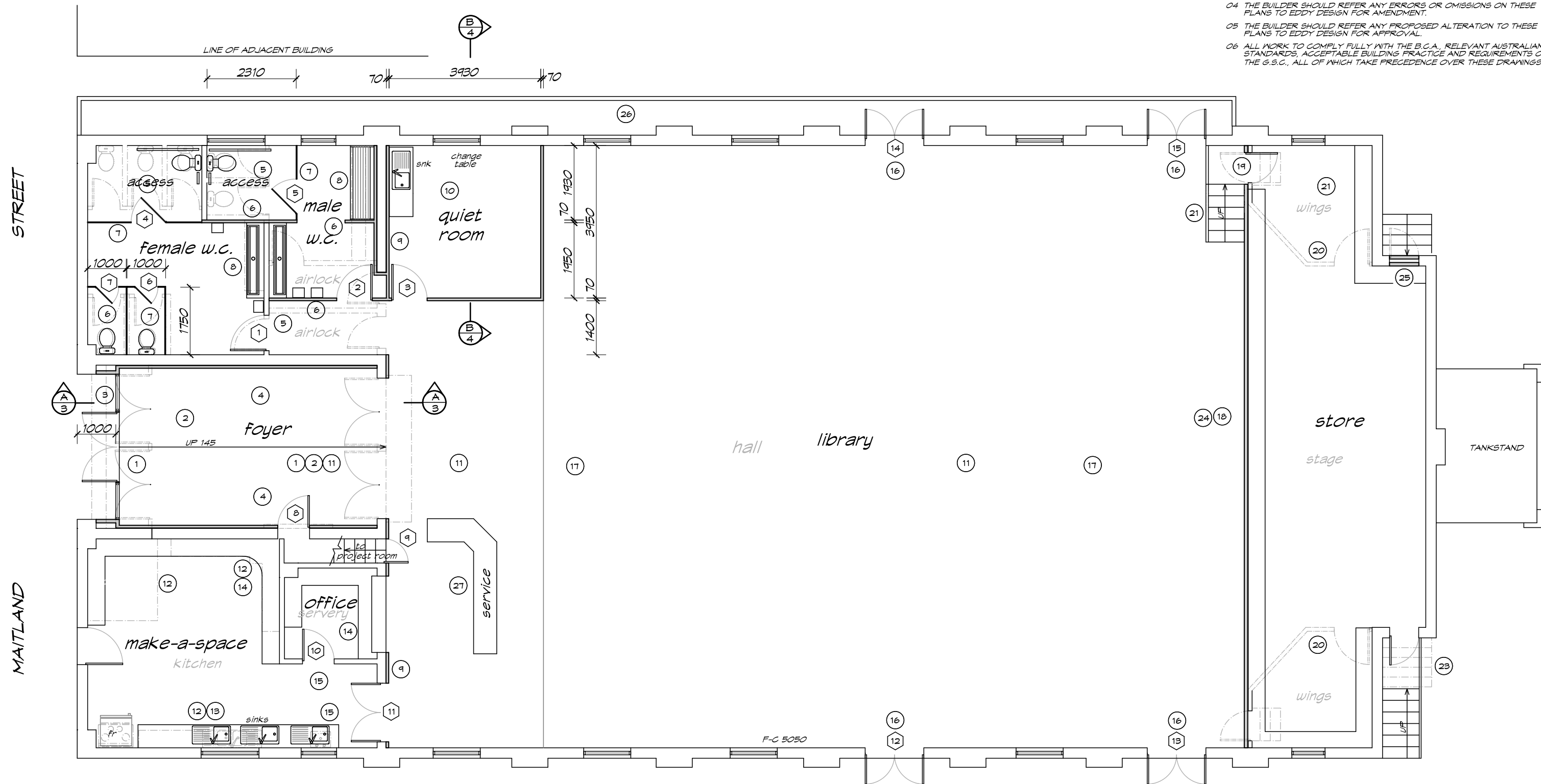

DOOR SCHEDULE

DOOR No	DOOR TYPE	REMARKS
D1-D2	2040 x 920 SEMI-SOLID INTERNAL	HYDRAULIC CLOSER AND EXT. PUSH PLATE, INT. GRAB HANDLE
D3	2040 x 920 SEMI-SOLID INTERNAL	PRIVACY LATCH
D4-D5	900 WIDE LAMINEX PARTITION DOOR	PRIVACY INDICATOR
D6-D7	700 WIDE LAMINEX PARTITION DOOR	PRIVACY INDICATOR
D8-D9	EXISTING	RE-SINING ON NEW WALL
D10-D11	SEMI-SOLID INTERNAL TO SUIT OPENING	REPLACE EXISTING. KEYED LEVER HANDLE LOCK
D12-D15	ALUMINIUM DOUBLE DOORS TO SUIT OPENING	GLASS PANELS. CRASH BARS. HYDRAULIC CLOSERS.

**ED EDDY DESIGN**  
 RESIDENTIAL COMMERCIAL & INDUSTRIAL DESIGN  
 ENERGY EFFICIENT DESIGN  
 PROJECT MANAGEMENT GENERAL DRAFTING  
 2 AVERN STREET INVERELL 2360  
 PHONE: 02 67210989 MOB: 0401 003 151  
 EMAIL: eddydesigninverell@gmail.com

THIS DRAWING IS THE COPYRIGHT OF EDDY DESIGN AND MUST NOT BE USED OR REPRODUCED, IN WHOLE OR PART, WITHOUT THE EXPRESS PERMISSION OF EDDY DESIGN.

Amendment "A" ~ Fixtures added. Store stairs relocated. P.C.E. 23/10/18

SCALE 1:100 AT A3	DRAWN P.C.E.	DRAWING <b>FLOOR PLAN</b>
AMENDMENT A	DATE 31/10/17	

PROJECT <b>PROPOSED REPURPOSING OF BINGARA CIVIC CENTRE for GWYDIR SHIRE COUNCIL MAITLAND STREET BINGARA</b>	DWG REF <b>1743</b> SHEET 1 OF
---	--------------------------------------